

# WAVE PERFORMANCE

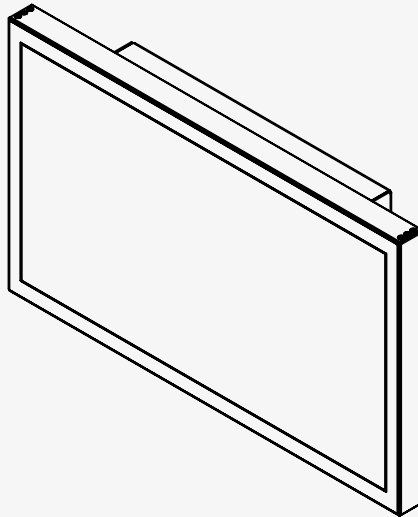

## SUMMARY

<b>ID</b>	30047	<b>CPU OPTION:</b>	<b>NORTH INVENT PART NO:</b>
<b>COMPANY NAME</b>	North Invent Norway	Celeron 4305UE @ 2.2 GHz	WE215 000 449
<b>VAT</b>	987884002VAT	i3-8145UE @ 2.2 GHz / 3.9 GHz	WE215 000 450
<b>ADDRESS</b>	Sørhauggata 128  5527 Haugesund NORWAY	i5-8365UE @ 1.6 GHz / 4.1 GHz	WE215 000 451
		i7-8665UE @ 1.7 GHz / 4.4 GHz	WE215 000 452
		NB! To order optional PSU versions and / or I/Os listed on the next page, please ask your North Invent representative for the correct P/N.	

## REVISION HISTORY

APPROVED	CHECKED	DRAWN	STATUS	DESCRIPTION
2020.01.29 OKJ	2020.01.29 OKJ	2020.06.12 RNO	Issued for Customer Review	First Revision

2018022201

1/4

Specifications subject to changes without prior notice. The contents of this page are property of North Invent Norway AS. All rights herein are reserved to North Invent Norway AS. This document cannot be reproduced without the written permission of the company.

**NORTH INVENT**  
Sørhauggata 128,  
NO-5527 Haugesund, Norway  
Phone: +47 48 84 02 00



# WAVE PERFORMANCE

The Wave PERFORMANCE Box is a state-of-the-art computer concept, derived from the interchangeable Electronics Unit of the already type approved Wave II monitors.

In addition to being a stand-alone box computer, the PERFORMANCE Box can be added on the back of a standard Wave II monitor to make up a Panel- PC (PPC); constituting the Wave PERFORMANCE Monitor. Extensive versatility allows for tailoring your optimal connections, SSDs, Memory and special features.

Designed for 10 years of manufacturing, the Wave PERFORMANCE Monitors are boasting powerful 8th Generation Intel® Core™ Processors. All Wave PERFORMANCE Boxes will remain fanless with low power consumption.

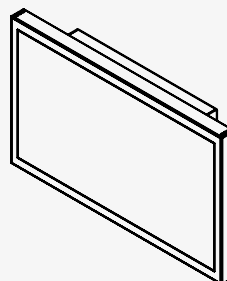

## TECHNICAL SPECIFICATIONS Wave PERFORMANCE 21.5" TOUCH

### MATCHING STANDARDS

IEC 60945, IEC 61174 (ECDIS), IEC 62.288 (Navigation), IEC 62.388 (Radar), IACS E10, EMC Directive-2014/30/EU, RoHS, REACH  
Compliant to a selection of MIL standards

DISPLAY SIZE	21,5" - 546.1 mm, Active area 476.64 (W) X 268.11 (H) mm
OVERALL DIMENSIONS	513.6 (W) x 310.6 (H) x 78 (D) mm
NET / GROSS WEIGHT	7.0 / 10.1 kg
RESOLUTION	Max 1920 x 1080 pixels (Full HD)
RESPONSE TIME	16 ms
CONTRAST RATIO	5000:1 (typ)
CPU	Intel® Celeron 4305UE, Core i3-8145UE, i5-8365UE, i7-8665UE
LIGHT INTENSITY	300 cd/m2 (typ)
GRAPHICS	Intel® UHD Graphics 620
VIEWING ANGLE	±89°
SSD	3 x M2 slot + SATA, configurable size 120 GB-2TB. Std configuration: 120 GB
SUPPLY VOLTAGE	18-36 VDC (90-264 VAC (IEC Inlet) or AC / DC Multipower optional).
POWER CONSUMPTION	Approx. 46W
RAM	DDR4 2400, configurable size. Standard configuration: 8 GB
ENCLOSURE PROTECTION	IP 67 from front given correct mounting and sealing.
GLASS TYPE	3mm Tempered, Anti Reflective Conturan®
INPUT/ CONTROL INPUT	2 x 10/100/1000 Ethernet (4 x 10/100/1000 optional), 2 x Display Port , x USB 3.1 2 x USB 2.0, 2 x RS232/RS485/422 + 2 x RS232 (D-SUB), Line in + Line out (mini Jack), HMI (15pD-Sub)
OPERATING / STORAGE TEMPERATURE	-15/+70° C, -15/+70° C (+5/+158° F, +5/+158° F)
BACKLIGHT LIFE	Typ 50.000 Hours
DIMMING RANGE	0-100%
OS SUPPORTED	Linux and Windows
TOUCH	10 Point PCAP Multitouch
COMPASS SAFE DISTANCES	Standard Compass 190 cm, Steering Compass 120 cm

2018101001

2/4

Specifications subject to changes without prior notice. The contents of this page are property of North Invent Norway AS. All rights herein are reserved to North Invent Norway AS. This document cannot be reproduced without the written permission of the company.

**NORTH INVENT**  
Sørhauggata 128,  
NO-5527 Haugesund, Norway  
Phone: +47 48 84 02 00



# WAVE PERFORMANCE

## TECHNICAL SPECIFICATIONS Wave PERFORMANCE 21.5" TOUCH

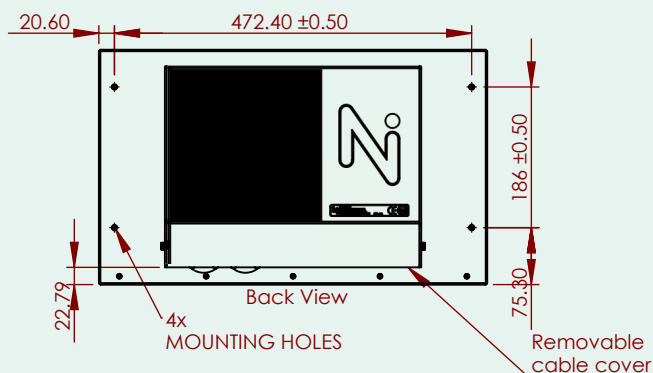
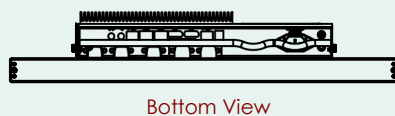
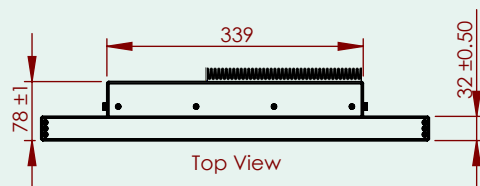
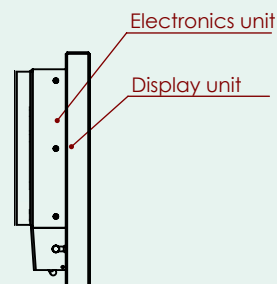
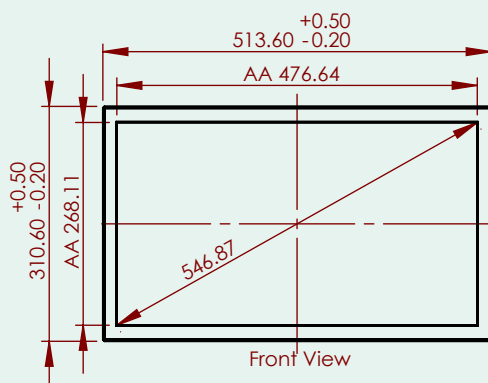

# WAVE PERFORMANCE

## TECHNICAL SPECIFICATIONS Wave PERFORMANCE 21.5" TOUCH

Included in Part 1 of 1

ITEM NO.	PART NUMBER	DESCRIPTION	QTY.

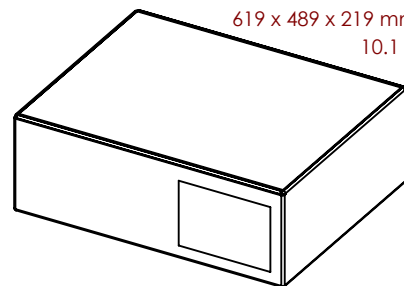
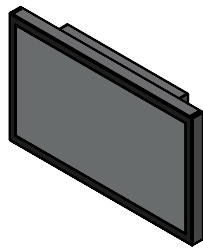

Part 1 of 1  
619 x 489 x 219 mm  
10.1 kg